

Modinex

Aluminium Cladding & Battens



Maintenance free design elegance

Delivering the natural beauty and timeless appeal of timber combined with the structural integrity of aluminium. Utilising our next generation MD-Dura timber grain coating, plain powder coat or anodised finishes, Modinex crafts aluminium that meets fire compliance regulations whilst offering a maintenance free design solution.

Modinex has a range of design solution, such as our signature Alu Seleкта profiles, Austratus clip-in battens and two piece aluminium battens. Modinex has invested to ensure all our collections are compliant with the current NCC2022 standard and exceed our client's expectations. One reason our clients return to us repeatedly is that we work as partners with them to provide a solution that meets industry requirements.



Alu Batten

Profiles

25mm series

25mm, 50mm, 100mm and 150mm depth available

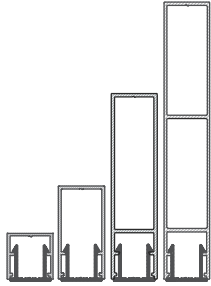

50mm series

25mm, 50mm, 100mm and 150mm depth available

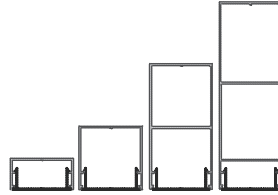

40mm series

40mm depth available



Alu Seleкта Channel

Profiles

75mm wide

18mm thickness available



155mm wide

18mm thickness available

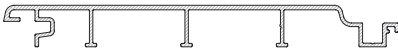

Features and benefits

Compliance — Sea salt spray certified

Fire rating — AS1530.1 non-combustible

Durability — 25-year structural & 15-year fading warranty (if plain or timber grain powder coating finish is used)

Availability — Manufactured 100% in Australia with a short lead time

Sustainability — Available in Green & Supergreen aluminium to reduce CO2 emissions by 50-75%

Design — Available in a range of plain colours or timber grain finishes

End caps — Available in a range of PVC or aluminium end caps

Features and benefits

Compliance — CodeMark, cyclone, sea salt spray certified

Fire rating — AS1530.1 non-combustible

Durability — 25-year structural & 15-year fading warranty (if plain or timber grain powder coating finish is used)

Availability — Manufactured 100% in Australia with a short lead time

Easy to install — Concealed fixings for a refined design and ease of installation

Seamless design — Specially designed interlocking tongue allows for secret fixing

Sustainability — Available in Green & Supergreen aluminium to reduce CO2 emissions by 50-75%

Design — Available in a range of plain colours or timber grain finishes

Curved design — 75mm wide profile can be curved to a convex radius of 700mm and the 155mm wide profile to a convex radius of 1200mm

Alu Seleкта Castellation

Profiles

40mm wide

20mm thickness available



160mm wide

20mm thickness available



Features and benefits

Compliance — CodeMark, cyclone, sea salt spray certified

Fire rating — AS1530.1 non-combustible

Durability — 25-year structural & 15-year fading warranty (if plain or timber grain powder coating finish is used)

Availability — Manufactured 100% in Australia with a short lead time

Easy to install — Concealed fixings for a refined design and ease of installation

Seamless design — Specially designed interlocking tongue allows for secret fixing

Sustainability — Available in Green & Supergreen to reduce CO2 emissions by 50-75%

Design — Available in a range of plain colours or timber grain finishes

Radius — 40 x 20mm profile is suitable for convex radius of 300mm or greater

Curved design — 75mm wide profile can be curved to a convex radius of 300mm

Austratus Linear & Austratus Linear DFM (Direct Fix)

Profiles



Flat series

29mm, 40mm, 60mm and 90mm wide available



Dowel series

32mm, 40mm and 60mm width available

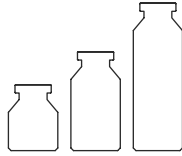

30mm Fin series

30mm, 40mm, 60mm, 90mm, 140mm and 190mm depth available



Fixing System

Austratus Linear

*Ideal for when the battens are not suspended, or acoustic insulation is required.

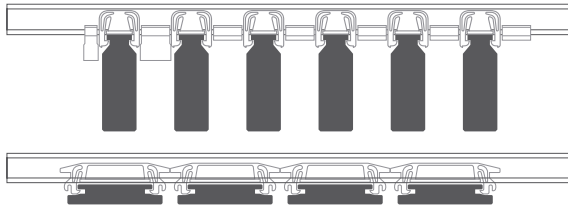

Austratus Linear DFM (Direct Fix)

*Ideal when the battens are not suspended or acoustic insulation is needed. No visible rails.

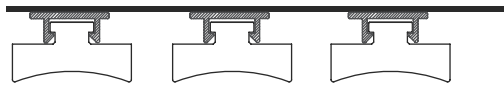

Features and benefits

Acoustic — Up to 0.9NCR acoustic rated insulation available

Fire rating — Group 1 fire rated

Sustainability — Profiles are available in a large range of sustainable timber species or in aluminium (Green or Super Green to reduce CO2 emission by 50-75%)

Application — Suitable for out of weather or external use

Austratus Grid

Profiles

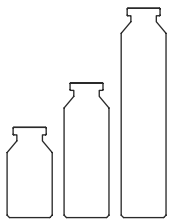

30mm Fin series

40mm, 60mm, 90mm, 140mm and 190mm depth available

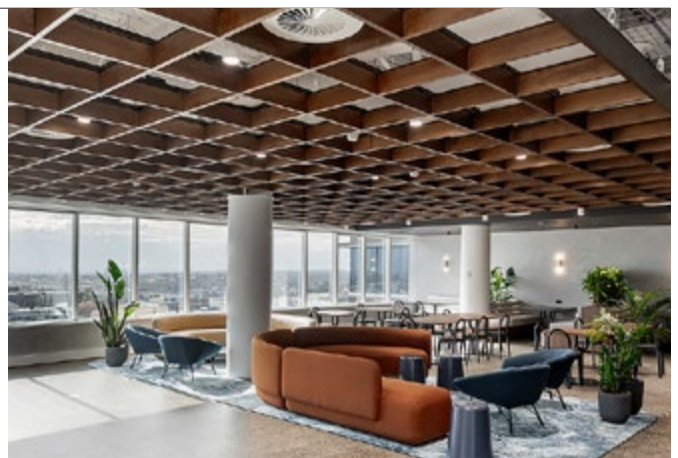

Aluminium Timber Grain Finishes

— MX DURA

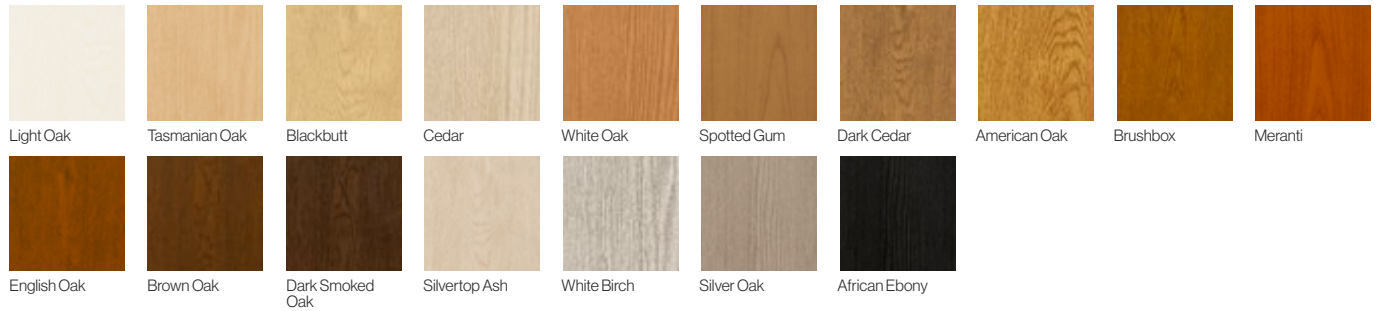

Solid Powder Coat Colours

— ALPHA



— METTALICO



— CHARISMA



— STRUTTURA

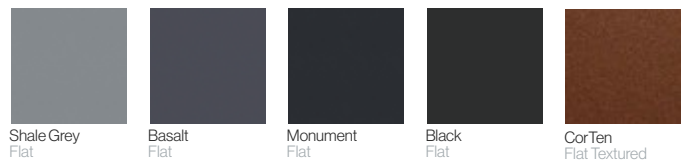

Anodised Colours

— MATT



— ILLUSTRIO



— BRIGHT





Sustainability

We deliver a maintenance free solution that is 100% recyclable



Modinex now offers Green and SuperGreen aluminium. 100% Australian-manufactured profiles and coatings, green aluminium produces around 50% less CO₂ emissions (8kg CO₂e/kg AL), and SuperGreen produces 75% less CO₂ emissions (4kg CO₂e/kg AL). Modinex is committed to Net Zero by 2050 and are working actively on reducing Scope 1 and Scope 2 emissions.

Modinex's aluminium profiles are ASI Certified with full Chain of Custody management. All aluminium profiles are 100% recyclable at the end of their life cycle. Using responsibly sourced lower-carbon aluminium on your next project is the right choice for the environment.



Specify with confidence

Leading with compliance, Modinex's Alu-Selektá Castelation and Alu-Selektá Channel profiles are CodeMark certified to NCC2022. This provides confidence and certainty to regulatory authorities and the market, whilst demonstrating that our design solutions comply with the National Construction Code (NCC).



Let us help you specify your next project

P — 1800 156 455

E — hello@modinex.com.au

Inspiration and product downloads

available at [modinex.com.au](https://www.modinex.com.au)

Modinex have a policy of continual improvement to specification. Product colours, grades, finishes and sizes may change without notice. Due to printing restraints, actual colours, grades, and finishes may vary from what is shown in this brochure. All information is current at the time of publishing this brochure. Please check our website for updated information and standards. March 2024 Publication.

